

# North Carolina Wildlife Regulations

## Urban Archery Season

**Archery only: Jan. 12 – Feb. 17, 2019**

### Information for Hunters

- The intention of the Urban Archery Season is to enable cities, towns and villages to reduce urban deer populations through increased hunter opportunity. Hunting during the Urban Archery Season is allowed **ONLY** in participating municipalities.
- Each city, town and village will decide if hunting is allowed on public property and restrictions, if any, for hunting on private property within the city, town and village limits.
- Hunters wishing to hunt in an area participating in the Urban Archery Season should call the participating city, town or village or visit its website to obtain a map showing lawful areas to hunt and additional information on specific restrictions that may apply to each area.
- **The Urban Archery Season DOES NOT obligate private landowners to allow hunting on their property, nor does it eliminate the ethical requirement for obtaining permission from the landowner before hunting. Hunters are legally required to obtain written permission to hunt on posted property.**
- Season bag and possession limits for both antlerless and antlered deer, including Bonus Antlerless Harvest Report Cards, that apply to the general archery, blackpowder, and gun deer seasons also apply to the Urban Archery Season.
- Deer of either sex may be harvested in participating areas during the Urban Archery Season.

# Urban Archery Area

This map shows possible urban archery areas in blue. This map combines parcels that are 2 acres in size or greater, areas outside of 250 feet from structures (2001 structure data), areas outside of 250 feet from parks and known gathering places, and areas outside of 250 feet of roadways. Other requirements that may limited hunting within the blue areas include, but are not limited to, 1) changes in structures since 2001, 2) NC Wildlife Commission rules, and dates of archery seasons, 3) written land owner permission. Be aware that the Town of Mount Pleasant Code of Ordinances is subject to change without notification.

This map is designed for general reference only, and data contained herein is subject to change. The Town of Mount Pleasant makes no warranty of merchantability or fitness for any purpose, expressed or implied, and assumes no legal responsibility for the information contained herein.

Town of Mount Pleasant

Urban Archery Area

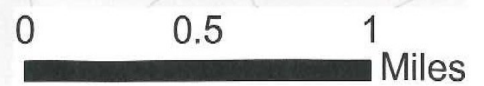
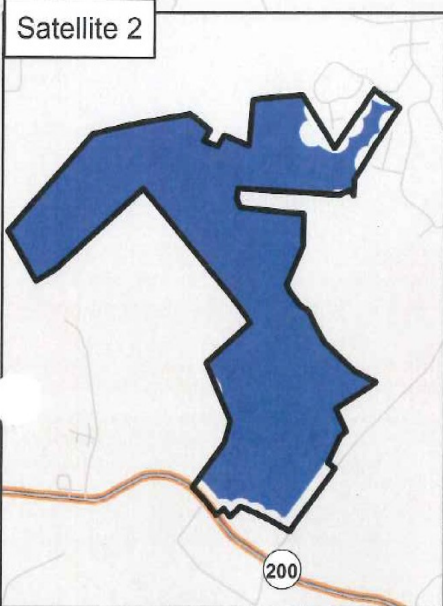
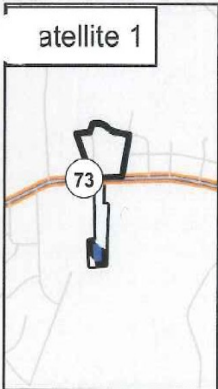
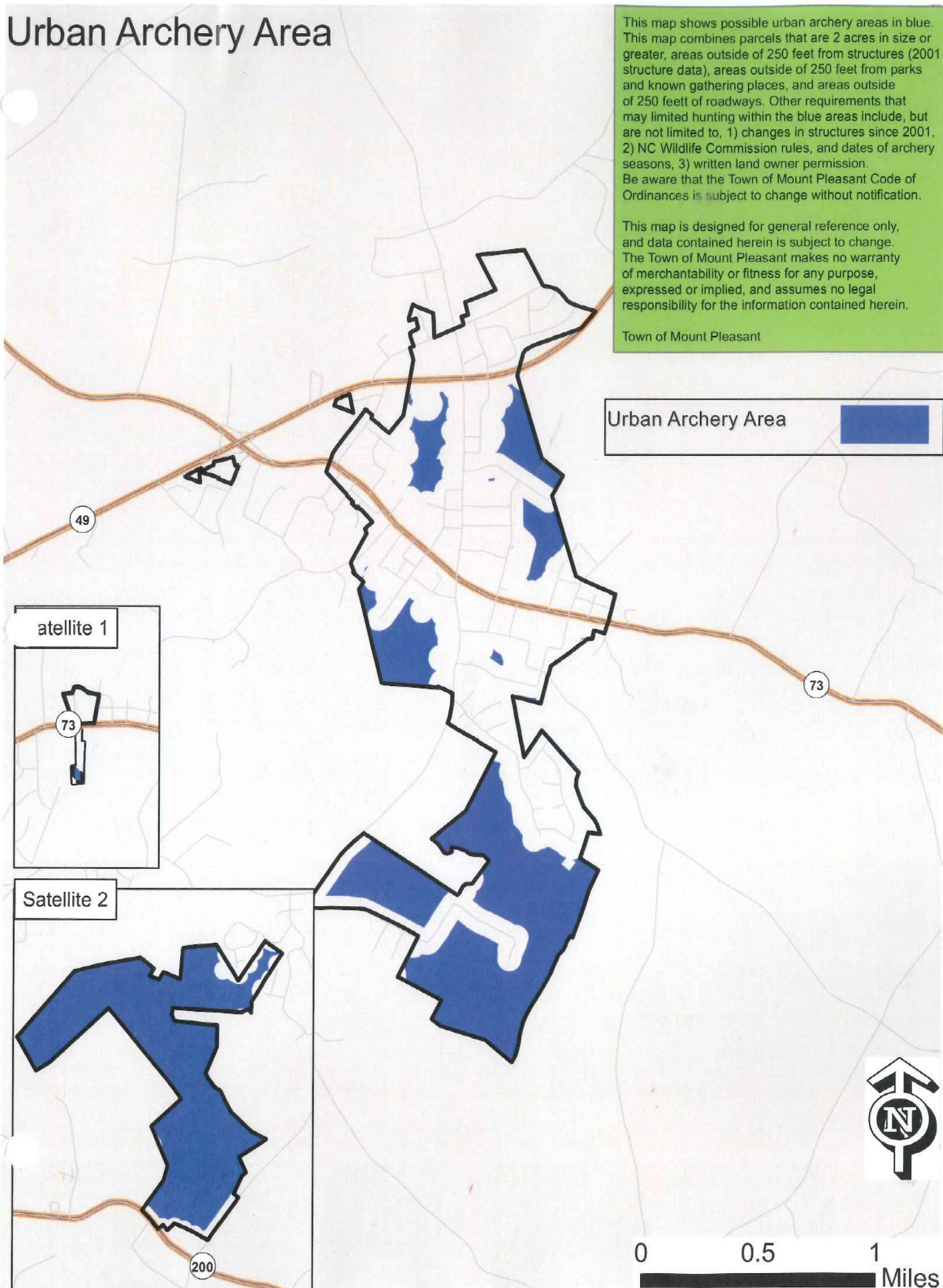

# LANDOWNER PERMISSION FORM

This certifies that \_\_\_\_\_ (and \_\_\_\_ guests) is/are authorized  
to enter upon the property of \_\_\_\_\_ for the purpose of  
*(full name)*  
*(landowner/lessee)*

\_\_\_\_\_  
\_\_\_\_\_  
\_\_\_\_\_

Permission is valid for the dates \_\_\_\_\_ to \_\_\_\_\_.

\_\_\_\_\_  
Date

\_\_\_\_\_  
Signature of landowner/lessee



The N.C. Wildlife Resources Commission provides this form as a public service for landowner/lessee and sportsmen use. Landowners/lessees are not required to use this form, but are encouraged to provide at least the information above when granting written permission.

(\_\_\_\_\_) \_\_\_\_\_  
Contact number

Revised 7/13/11

# LANDOWNER PERMISSION FORM

This certifies that \_\_\_\_\_ (and \_\_\_\_ guests) is/are authorized  
to enter upon the property of \_\_\_\_\_ for the purpose of  
*(full name)*  
*(landowner/lessee)*

\_\_\_\_\_  
\_\_\_\_\_  
\_\_\_\_\_

Permission is valid for the dates \_\_\_\_\_ to \_\_\_\_\_.

\_\_\_\_\_  
Date

\_\_\_\_\_  
Signature of landowner/lessee



The N.C. Wildlife Resources Commission provides this form as a public service for landowner/lessee and sportsmen use. Landowners/lessees are not required to use this form, but are encouraged to provide at least the information above when granting written permission.

(\_\_\_\_\_) \_\_\_\_\_  
Contact number

Revised 7/13/11